

## REMOVING THE WATER DISPENSER FILL TUBE

### **⚠ WARNING**



**Electrical Shock Hazard**  
Disconnect power before servicing.  
Replace all panels before operating.  
Failure to do so can result in death or electrical shock.

NOTE: Sharp edges may be present.

1. Unplug the refrigerator or disconnect the power.
2. Pull out the ice & water dispenser drip tray.



3. Position the drip tray upside down under the ice & water dispenser control panel, and pry the bottom edge of the panel out at the two small slots with a large-bladed screwdriver.

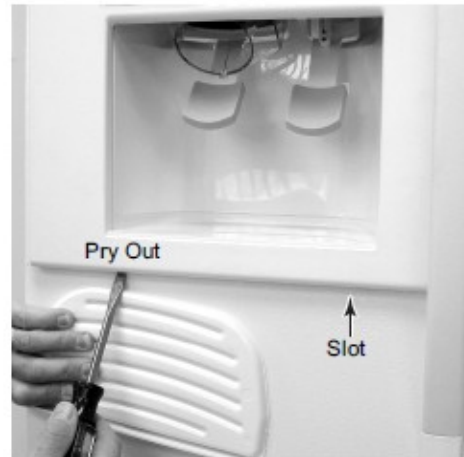

4. Disconnect the control panel switch connector from the wiring harness and remove the panel.

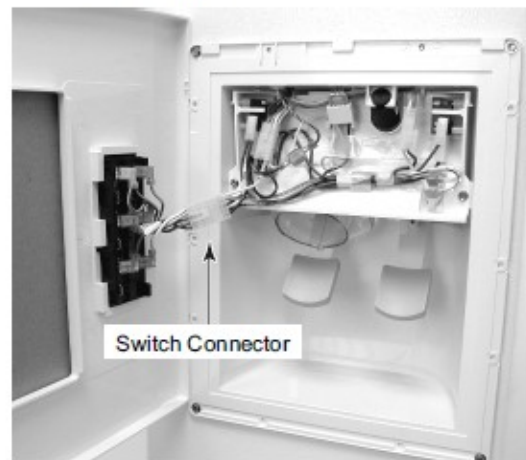

5. Disconnect the three wire connectors and the green ground wire from the switch subpanel.
6. Remove the two hex-head screws from the switch subpanel and remove the panel.

3 Wire Connectors & Ground Wire

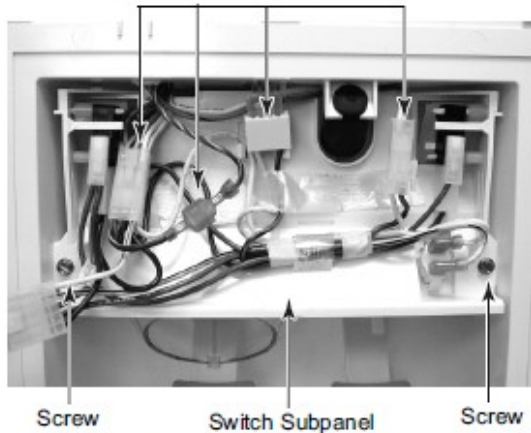

7. Open the refrigerator and freezer doors and remove the two screws from the base grille and remove the grille from the front of the unit.



8. Place a container near the base grille to catch the water in the next step.

9. Disconnect the water dispenser fill tube from the union, slide the nut off the end of the tube, and allow the water to drain into the container.
10. If possible, pull the water dispenser fill tube through the wire tie, or cut the tie.

Wire Tie



Water Dispenser Fill Tube Nut

11. At the dispenser, pull the water dispenser fill tube out of the dispenser hole.
12. Remove the water dispenser fill tube bracket from the end of the old fill tube and install it on the end of the new tube. Leave approximately 1" of tubing for the spout.

Fill Tube Bracket

