

REMOVING THE CONSOLE AND THE TOUCHPAD/LED ASSEMBLY

⚠ WARNING



Electrical Shock Hazard
Disconnect power before servicing.
Replace all parts and panels before
operating.
Failure to do so can result in death or
electrical shock.

1. Unplug washer or disconnect power.
2. Turn off the water supply to the washer.
3. Remove the three T-20 hex-head Torx screws from the top cover of the washer.
4. Pull back on the cover and release the tabs in the console from the slots in the cover, then lift the cover off the unit.

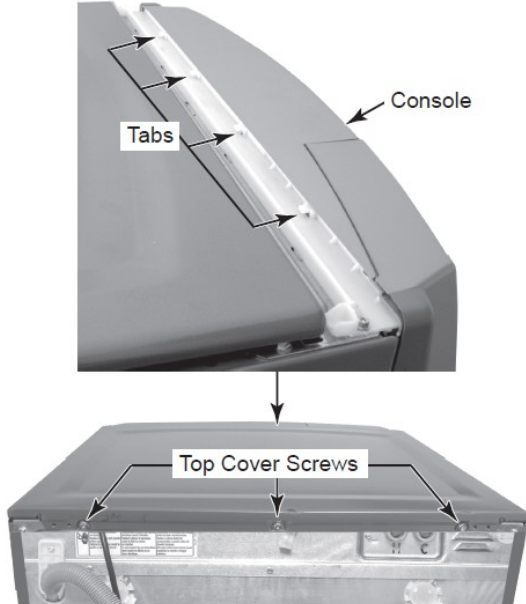

5. To remove the console:
 - a) Pull out and disconnect cable connector UI8 from the central control unit.
 - b) Remove the cable wires from the two central control unit clips.

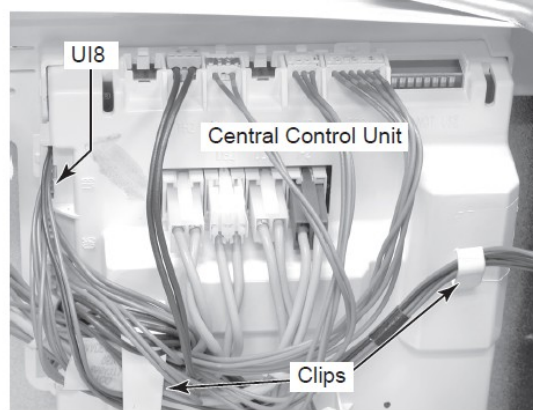

- c) Pull the detergent dispenser drawer out as far as it will go, then press down on the release tab, and remove the drawer from the unit.



- d) Remove the two screws at the recessed hole and bottom of the console.

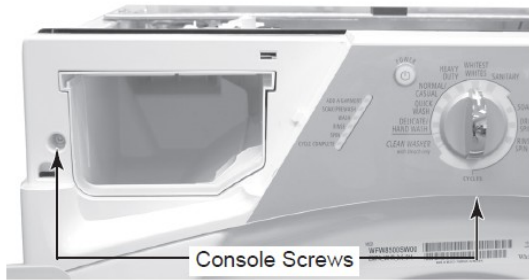

- e) Lift the top edge of the console and unhook it from the holder clips.

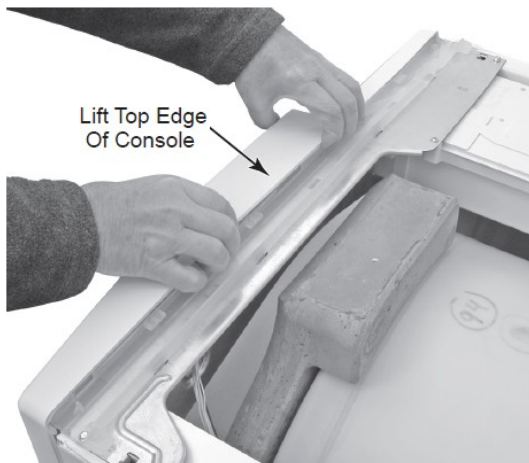

- f) Press the locking tab on the right rear side of the console inward, and remove the console.

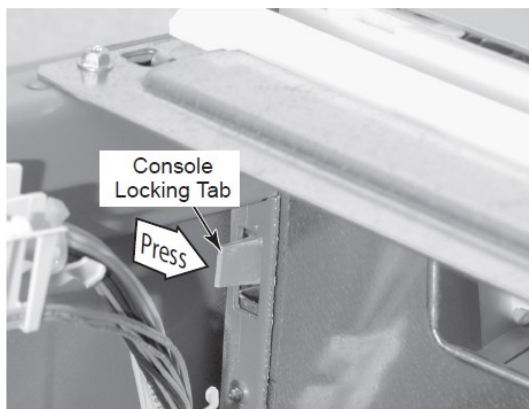

6. To remove the touchpad/LED assembly:

- a) Pull the selector knob off the switch shaft.
b) Press the seven console locking tabs, and unsnap the touchpad/LED assembly, then lift the assembly from the console and remove it.

