

Dispenser

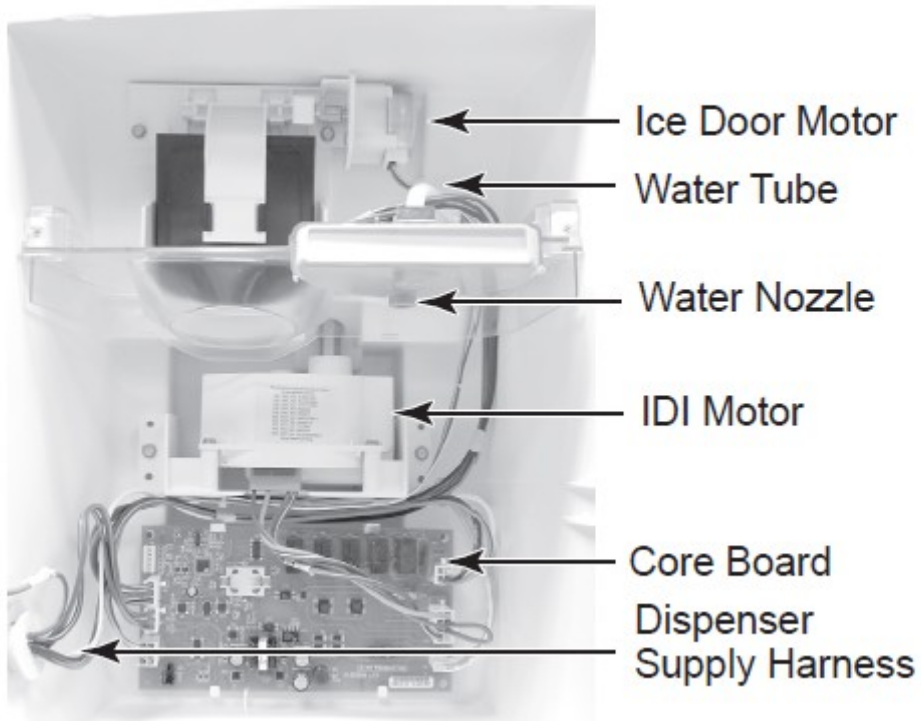

1. Unplug refrigerator or disconnect power.
2. Pull the dispenser drip tray out as far as it will go, then press down to release the catch, pull the tray out all the way and remove it from the dispenser.
3. Remove the two screws from the dispenser cover assembly.



4. Pull out at the bottom, lift up on the dispenser cover assembly, and remove the assembly from the refrigerator door.



5. Disconnect the dispenser cover 3-wire connector from the user interface board, and the ground wire connector from the ground wire harness.

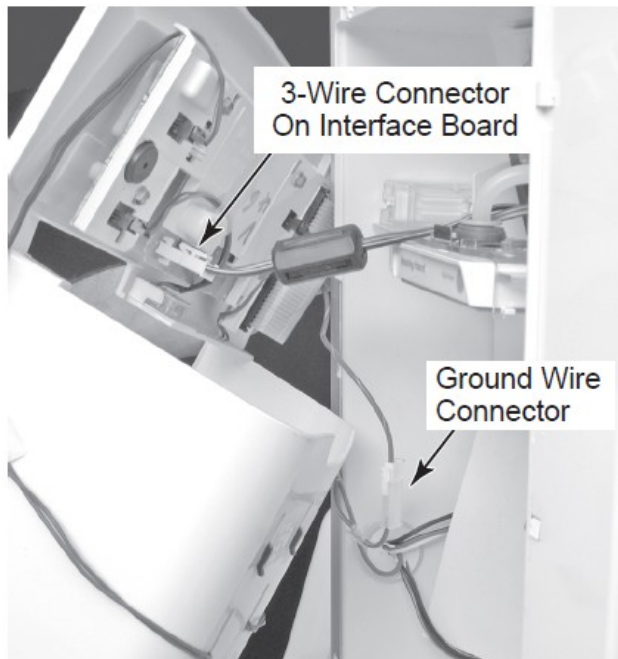

To remove the IDI motor:

- a) Open the freezer door.
- b) Press in on the release button and remove the ice bin from the door shelf.



- c) Remove the two screws from the hex drive shaft coupling holder and remove the coupling assembly.

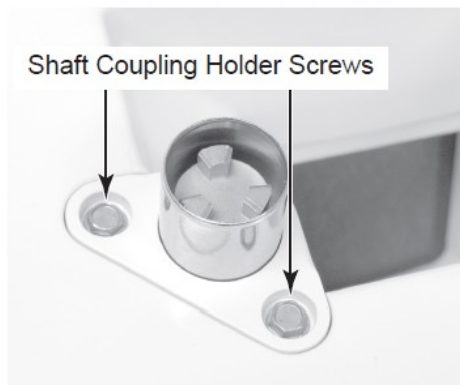

- d) Lift the spring and hex drive shaft up and out of the door.

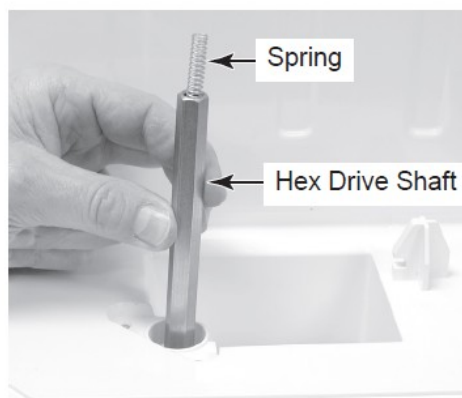

- e) Remove the boot from the top of the IDI motor.
- f) Disconnect the motor connector from the IDI motor.
- g) Unclip the wires from the retainers under the IDI motor housing.
- h) Remove the three screws from the IDI motor housing and remove the motor and housing from the dispenser.

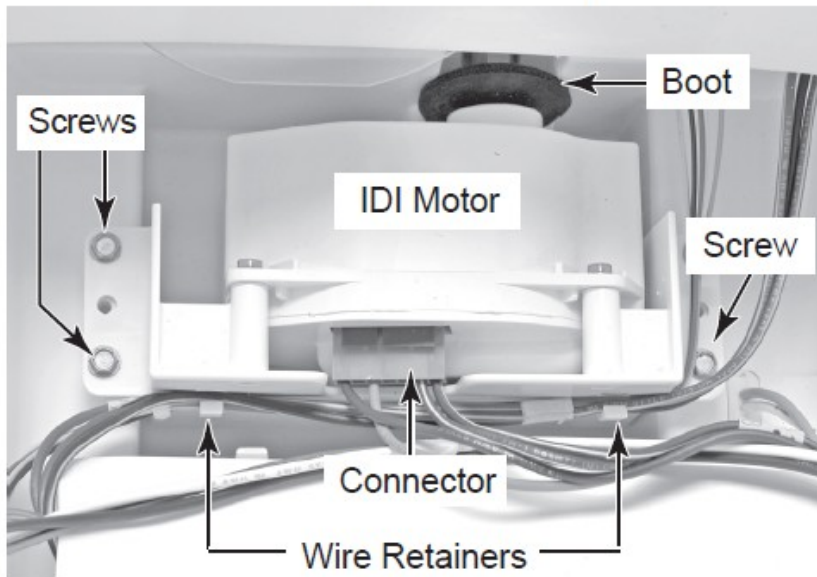

- i) Remove the four screws from the IDI motor and remove the motor from the housing.

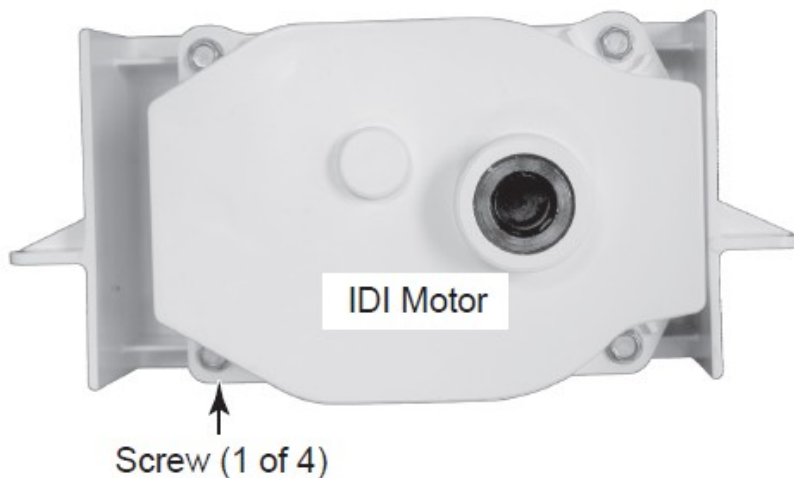

IDI MOTOR



Set the ohmmeter to the R x 1 scale.

Touch the ohmmeter test leads to the following motor connector pins:

Pins 1 and 2 = 10 to 15 Ω

Pins 4 and 5 = 220 to 270 Ω