

## Refrigerators

### New Design Ice & Water Dispenser

[R-355 / 4322184 / March 1997]

The new design ice and water dispenser provides improved performance and is easier to use. These are some of its unique and outstanding features:

1. Clean-Touch switches on the front cover perform the following functions (depending on model). (Fig. 1)
  - Switch between cube or crushed ice feature.
  - Turn on and off dispenser light.
  - "Lock out" operation of dispenser functions.
2. Lever activated dispenser light (some models).
3. The overflow grille can be removed and cleaned.
4. Dispenser levers have equal travel and are easier to push.
5. Silent delay mechanism is used on the ice chute door closer.
6. Ice door and housing heaters virtually eliminate sweating.

#### SERVICING THE ICE AND WATER DISPENSER

The new ice and water dispenser is a simplified design, using half the number of parts as the previous design. Since the new dispenser is "foamed-in" the freezer door, it cannot be removed as an assembly, however it can be easily serviced. Following are the steps for disassembly:

	<b>! WARNING</b>
	<b>Electrical Shock Hazard</b>
	<b>Disconnect power before servicing.</b>
	<b>Failure to do so can result in death or electrical shock.</b>

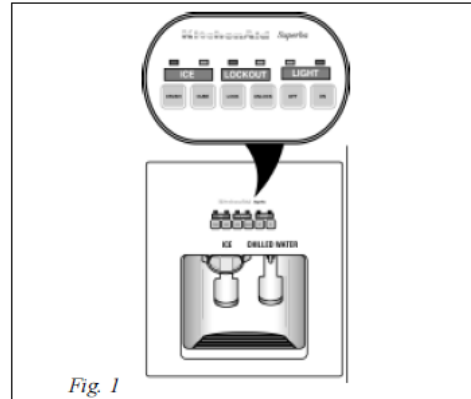

Fig. 1

1. Unplug the refrigerator power cord.
2. Remove the overflow grille from the housing.
3. Unsnap front cover at the bottom of the housing. (Fig. 2)
4. Disconnect the front cover switch harness connector and set the cover aside.

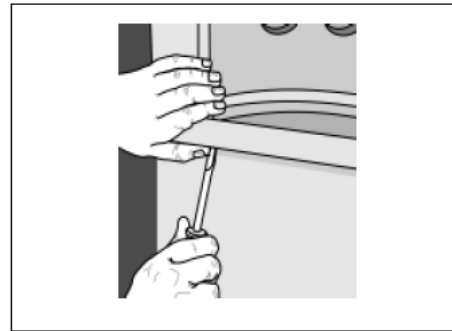

Fig. 2

Refer to Figure 3 for the following steps.

5. Disconnect the power wire harness connector (BL/BK and W wires)
6. Disconnect the flapper door heater wire harness connector (if one is present).
7. Release the dispenser microswitch retainers and slide the switches off of their locator pins. Carefully handle the switches so they do not come apart.
8. Disconnect the wires from the terminals of the lamp holder. (Fig. 3)

9. Remove the two 1/4" hex head screws from the control bracket and remove the control bracket.
10. Remove the 1/4" hex head screw to remove the water fitting (fill spout) from the water dispenser lever.
11. Unsnap the ice guide and remove it from the ice dispenser lever.

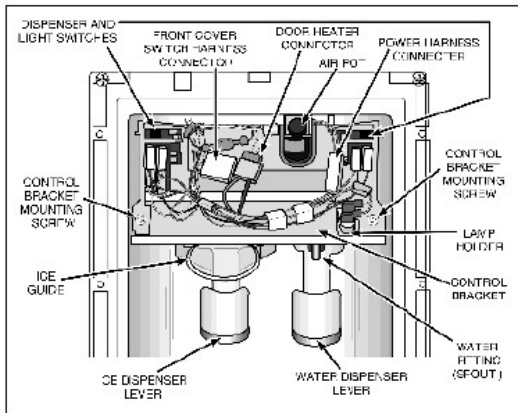

Fig. 3

**Refer to Figure 4 for the following steps.**

12. Remove the air pot by sliding the rear of the air pot out of the slot molded to the dispenser housing and slip the linkage out of the flapper door mechanism assembly.
13. Unsnap the flapper door and remove it from the ice dispenser lever. While you remove the flapper door, carefully guide the flapper door heater wire and connector over the door mechanism assembly.
14. Remove the 1/4" hex head screw securing the dispenser levers pivot retainer to the dispenser housing and remove the retainer.
15. Remove the water dispenser lever.
16. Remove the ice dispenser lever by maneuvering it around the door mechanism assembly.
17. Pull the pin from the door mechanism assembly and remove the spring and mechanism assembly.
18. Reassemble in reverse order.

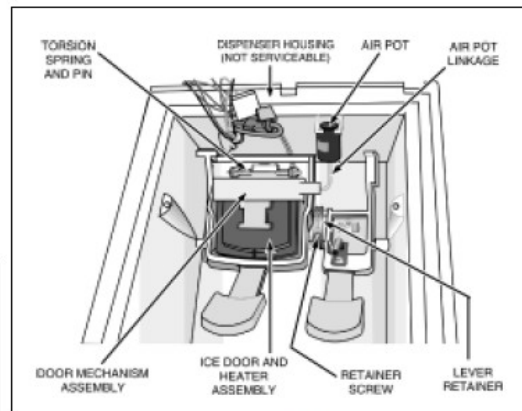

Fig. 4

### SERVICE REPLACEMENT PARTS

If the Front Housing Cover or Switch Assembly are damaged and must be replaced, these items are only available in the Front Cover Assembly. (Fig. 5) This assembly consists of the following parts:

- Front Housing Cover
- Switch Assembly
- Wire Assembly
- Front Cover Plaque

Be sure to order using the model number of the refrigerator/freezer being serviced.

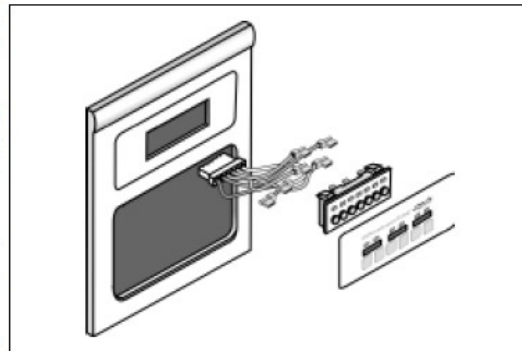

Fig. 5