

Reassembly

To remove & install impeller (using kit # 167085):

- ✖ While holding motor fan so shaft won't spin (1a), unscrew impeller counterclockwise (1b).
- ✖ Rotate pump housing counterclockwise until tabs clear, then lift housing from motor (2).
- ✖ Remove spring and O-ring from pump housing, then lift spacer up from motor shaft (3).
- ✖ Place replacement spacer onto motor shaft (4). Note larger end goes onto shaft 1st.
- ✖ Install replacement spring & O-ring onto pump housing, then line up housing-motor tabs to screw pump housing onto motor (5a). Screw replacement impeller onto motor shaft (5b).
- ✖ Align motor to pump housing with capacitor @ 11:00 position to facilitate reassembly.

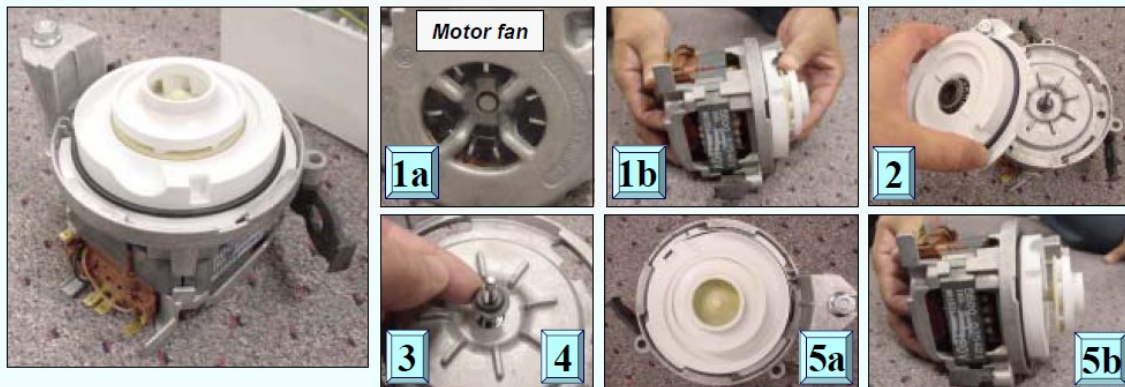

Service Tips -- Measuring Pump Resistance @ Control Module (1)

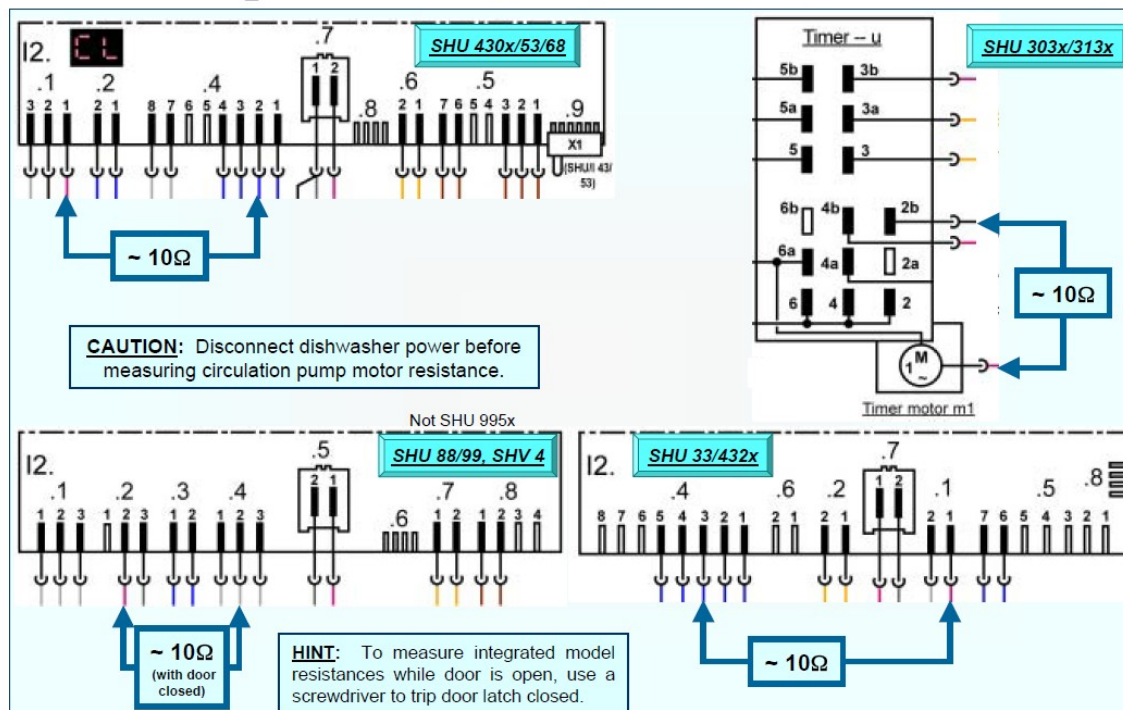

Service Tips -- Measuring Pump Resistance @ Control Module (2)

HINT: To measure integrated model resistances while door is open, use a screwdriver to trip door latch closed.

~ 10Ω (with door closed)

HINT: Can also measure between **VT** wire on terminal # 2 on e1 door switch and **GY** wire on module terminal I2.7-1.

Door Switch – e1

CAUTION: Disconnect dishwasher power before measuring circulation pump motor resistance.