

REMOVING THE OVEN DOOR

1. To remove the oven door, open the door to its first stop.
2. Grasp the sides of the door, lift it slightly, and pull the door forward until the hinge hangers are **partially** out of the slots in the chassis. Do not completely remove the hinge hangers from the slots, since there will be spring tension on them.
3. Reposition the angle of the door to its vertical position to remove the spring tension on the hinge hangers, then pull the hangers the rest of the way out of the chassis slots.

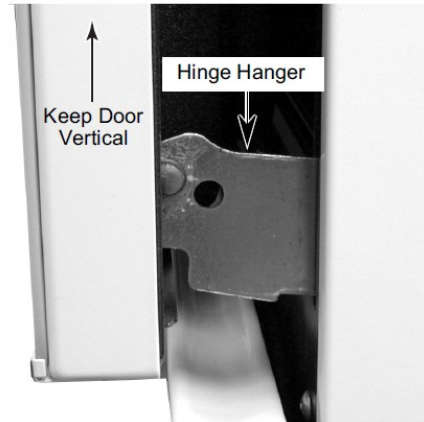
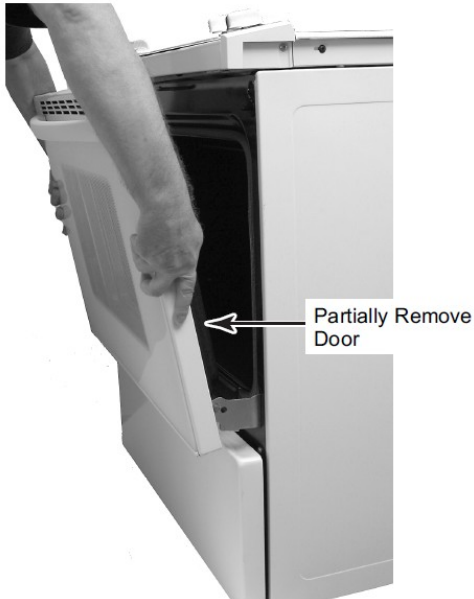

To reinstall the oven door:

1. Grasp the sides of the door and insert the hinge hangers into the hinge slots. Lift the door slightly and push in at the bottom until the hangers are fully installed in the unit. NOTE: If the hinge hangers are not seated properly, the door will not close tightly and may be off-center. To seat the hinge hangers, keep the door vertical, then lift it slightly, and push in on the bottom until the hangers are fully seated.
2. Open and close the oven door to make sure that it operates and seals properly.